

cornercard



**ÈID SECURE COMMERCE  
SAFER ONLINE SHOPPING**

**Cornèrcard prioritises the safety of clients when shopping online. To keep clients secure, we employ security features to ensure authentic transactions; cardholders will be asked to validate transactions for big online purchases, using the eID Secure Commerce app (for iOS and Android devices).**

The app allows the authorisation of online transactions using a biometric factor which ensures a strong customer authentication to make online shopping safe – we encourage you to download and start using it immediately.

To register for the app, we must have a valid phone number registered against your card. Contact us on +423 388 99 99 or log in to the card24 App to ensure your phone number is up to date.



# REGISTRATION STEPS

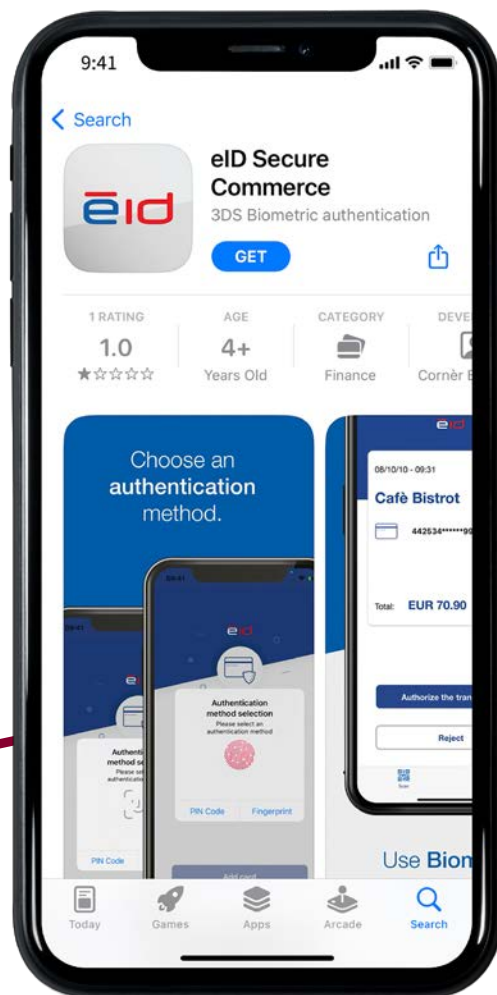

01

Download 'eID Secure Commerce' from the Apple App Store or Google Play Store.

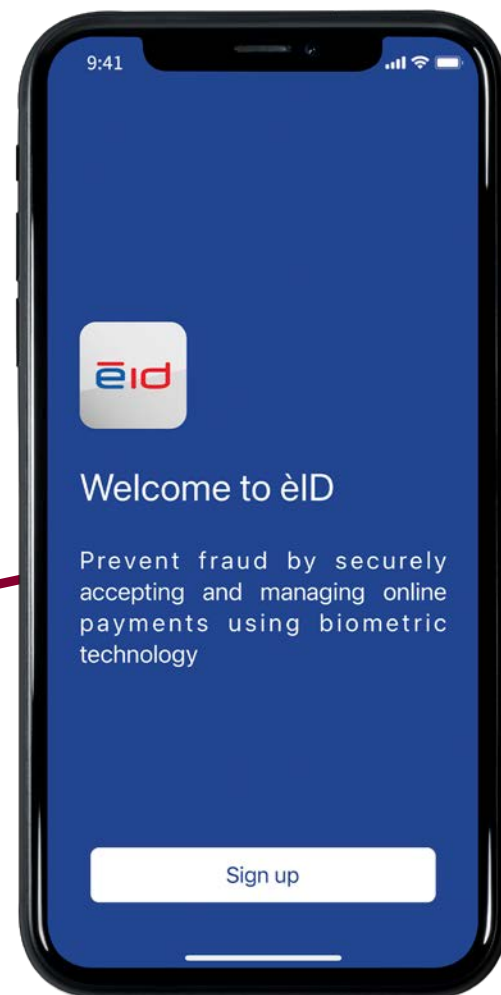

02

Open the app, select 'sign up' and follow the instructions.

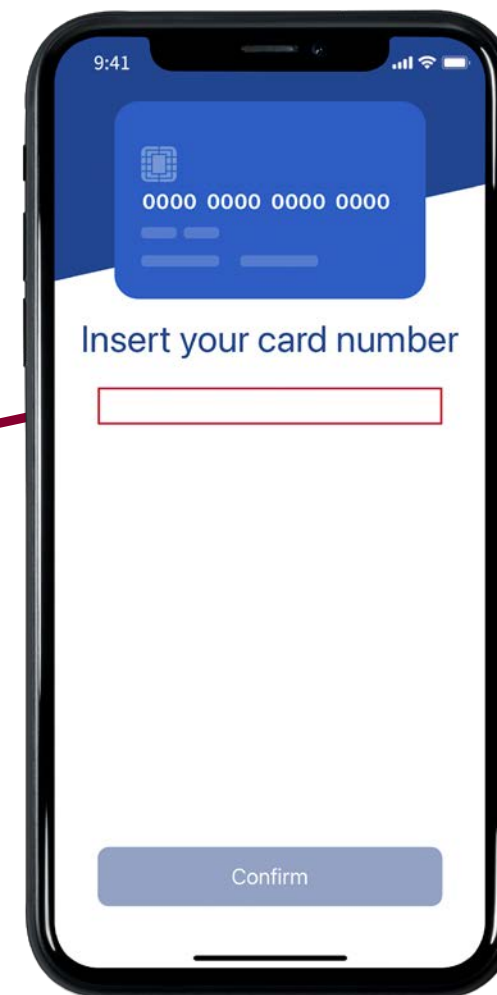

03

Enter your card number when prompted.

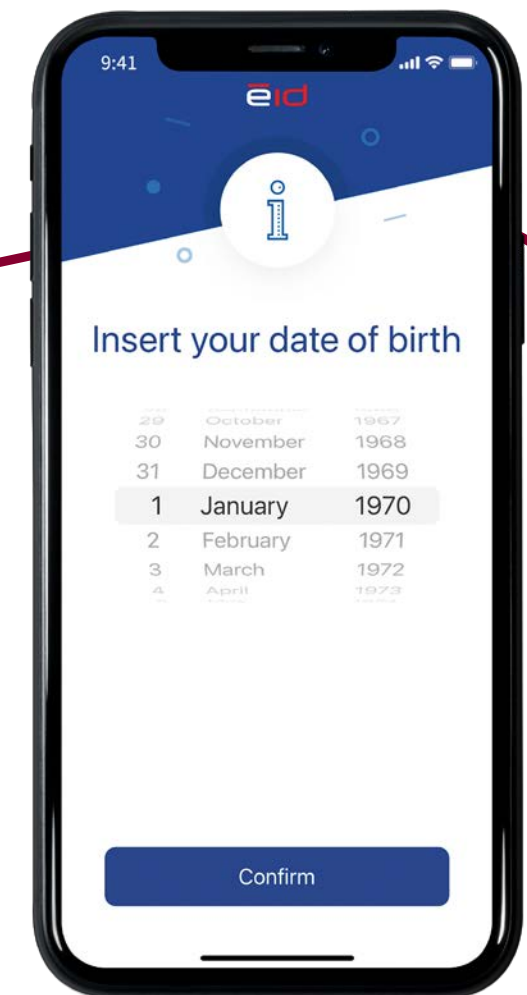

04

Enter your date of birth.

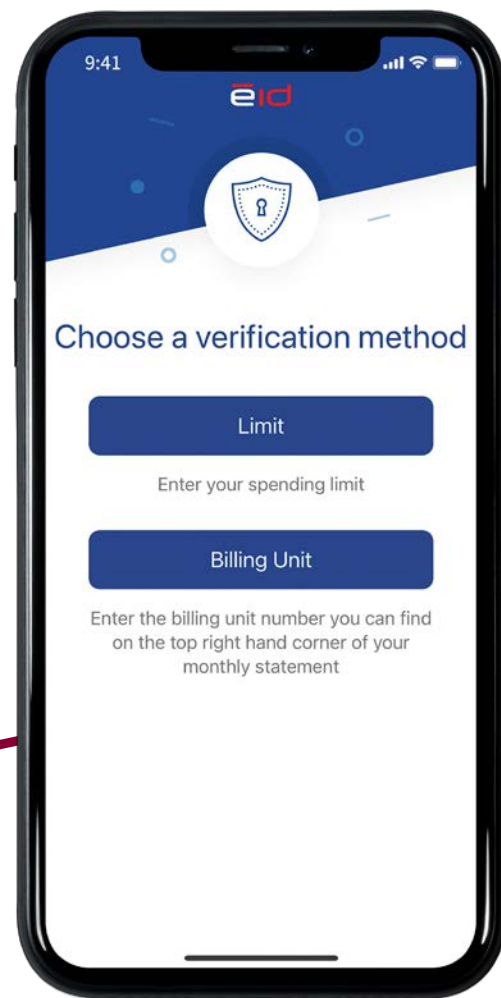

05

Select a verification method:  
Credit limit or Billing unit.

- Billing unit is listed on the letter received with your new card, or can be found on the monthly statement.
- Limit refers to the monthly spending limit assigned to your credit card.

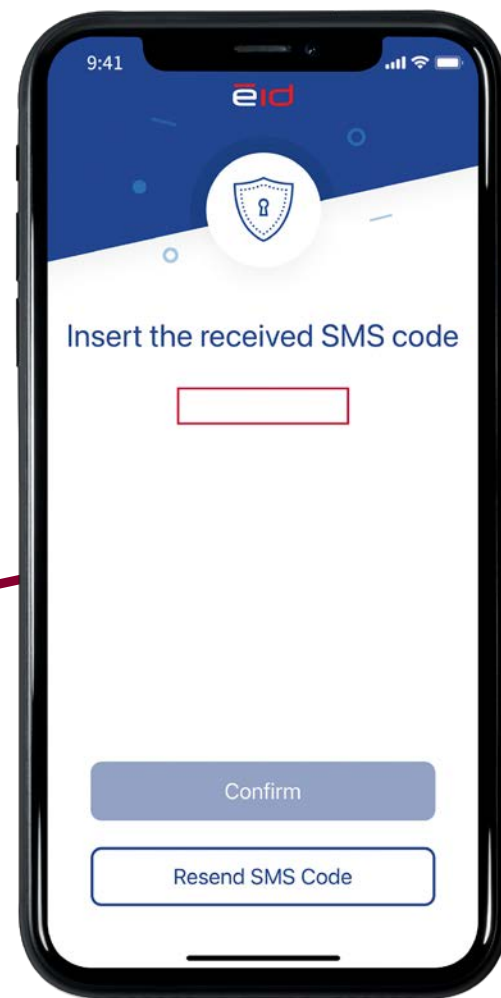

06

Enter the code sent by SMS  
to the registered phone.

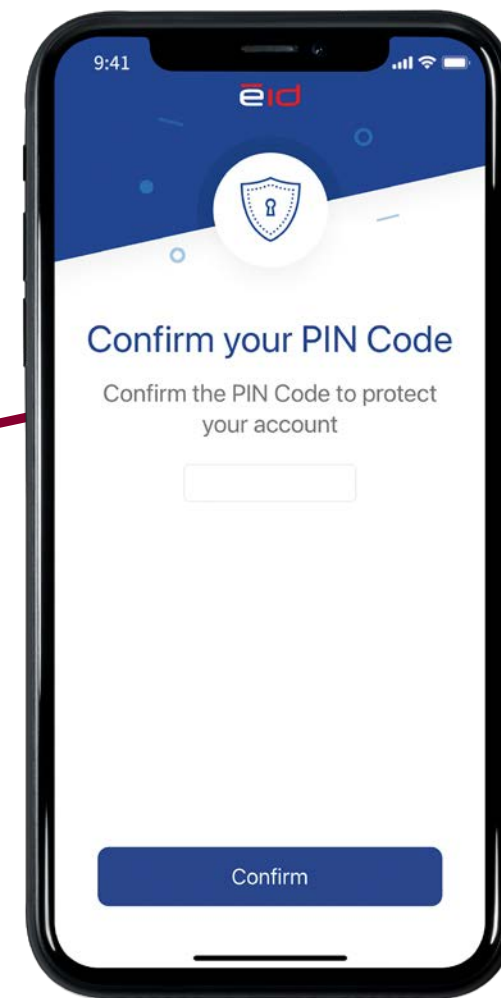

07

Create and verify a security  
code to access the app.

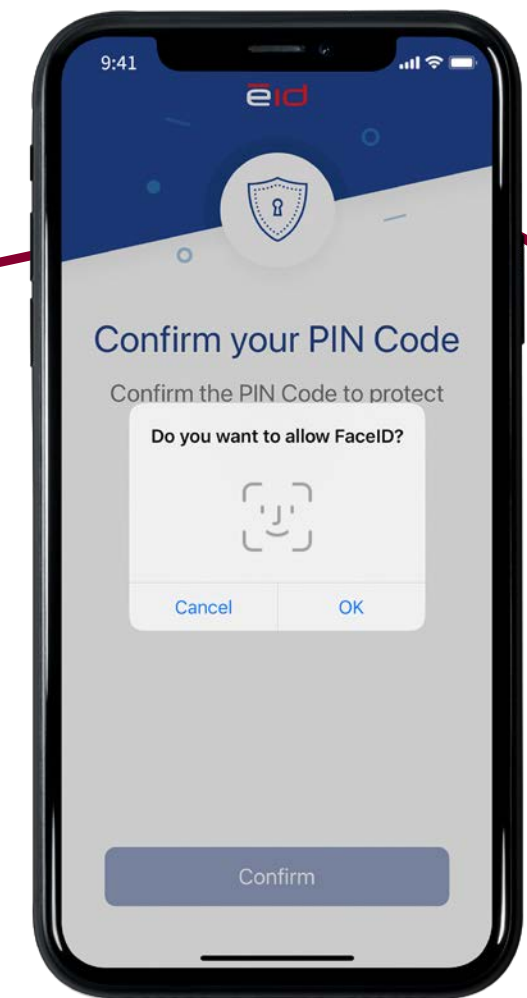

08

Enable biometric  
authentication and select  
preferred method.

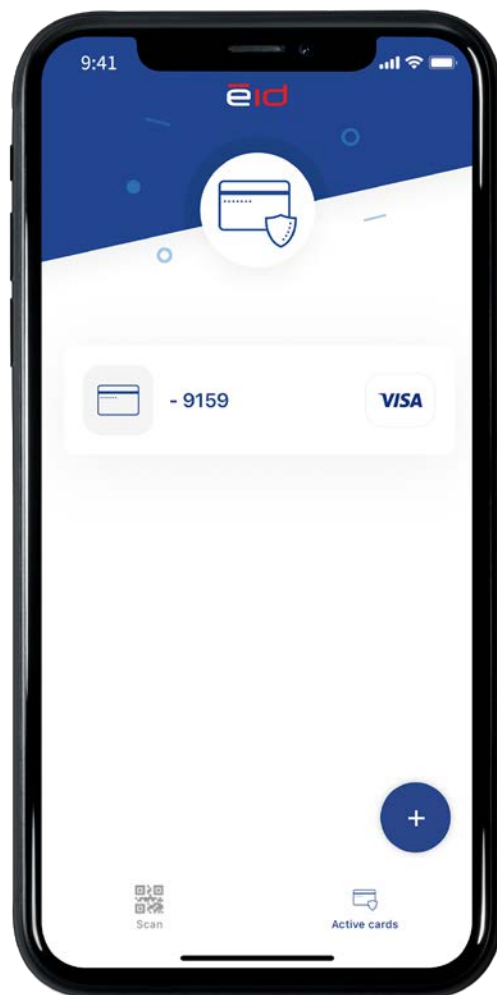

09

Select 'add card' to add one or all of your cards.

## SHOP SAFER ONLINE

Transactions that require additional verification will send a push notification to your phone – and you'll be directed to the app to either validate or decline the transaction.

You may not need to validate every transaction, as our sophisticated monitoring systems will request validation only when authenticity is questioned.